

Top Hall 2011

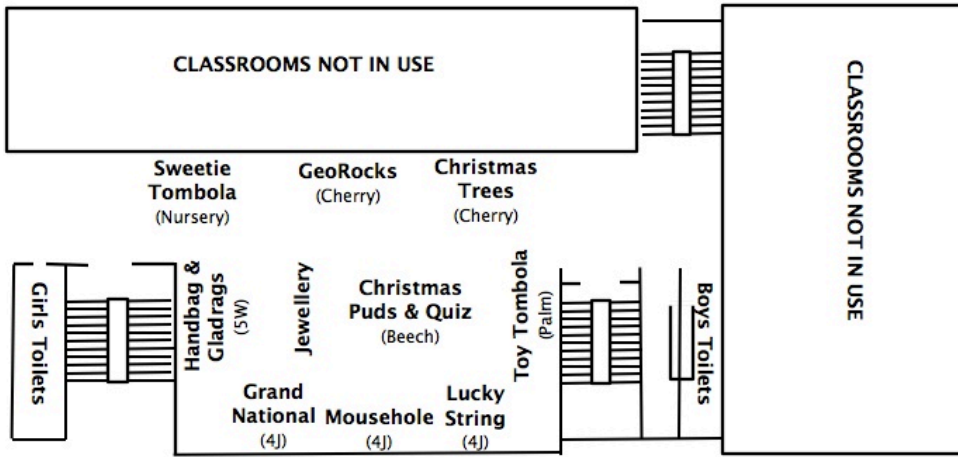

- Top Hall**
- 1/Sweetie Tombola
 - 2/Geo Rocks
 - 3/Christmas Trees
 - 4/Hand Bags & Glad Rags
 - 5/Jewellery
 - 6/Christmas Puds & Quiz
 - 7/Toy Tombola
 - 8/Grand National
 - 9/Mousehole
 - 10/Lucky String

Middle Hall 2011

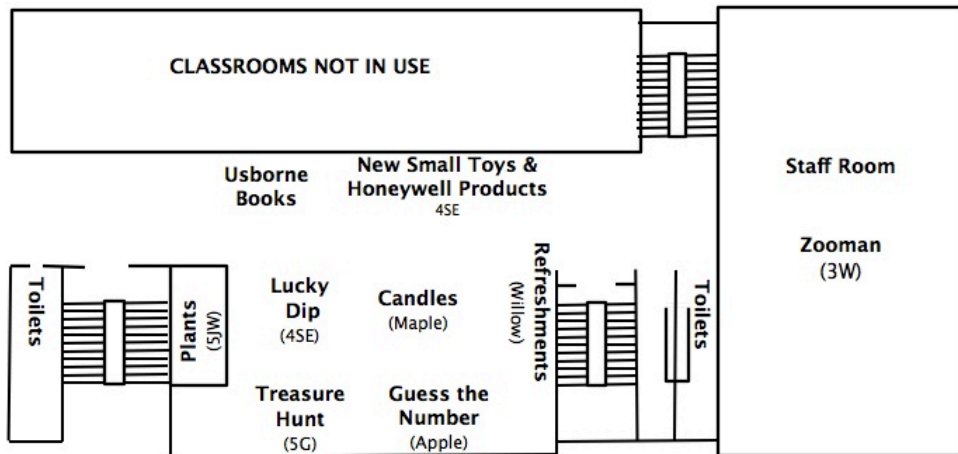

- Middle Hall**
- 1/Usborne Books
 - 2/ New Small Toys & Honeywell Products
 - 3/Plants
 - 4/Lucky Dip
 - 5/Candles
 - 6/Refreshments
 - 7/Treasure Hunt
 - 8/Guess the Number

Bottom Hall 2011

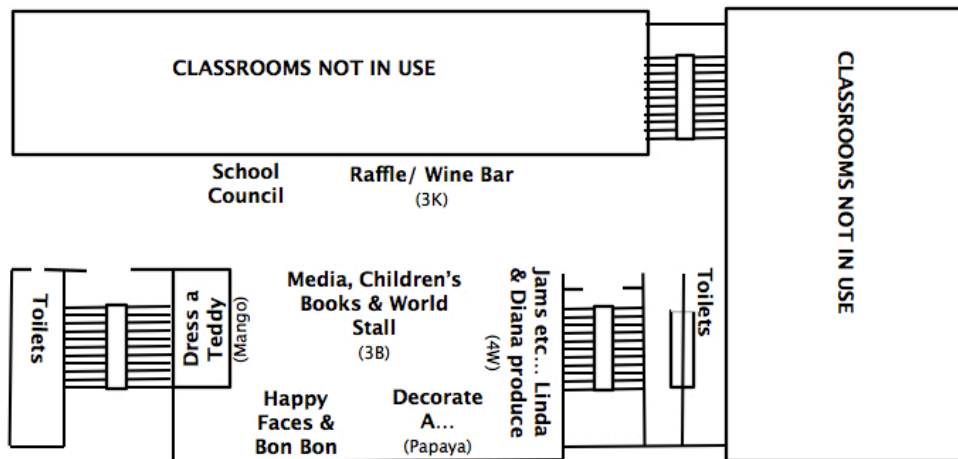

- Bottom Hall**
- 1/School Council
 - 2/Wine Bar & Raffle
 - 3/Dress a festive Teddy
 - 4/Media, Childrens Books & World Stall
 - 5/Linda & Diana's Jams, Preserve & cakes
 - 6/Happy Faces & Bon Bon
 - 7/Decorate a Christmas Tree

Outside 2011

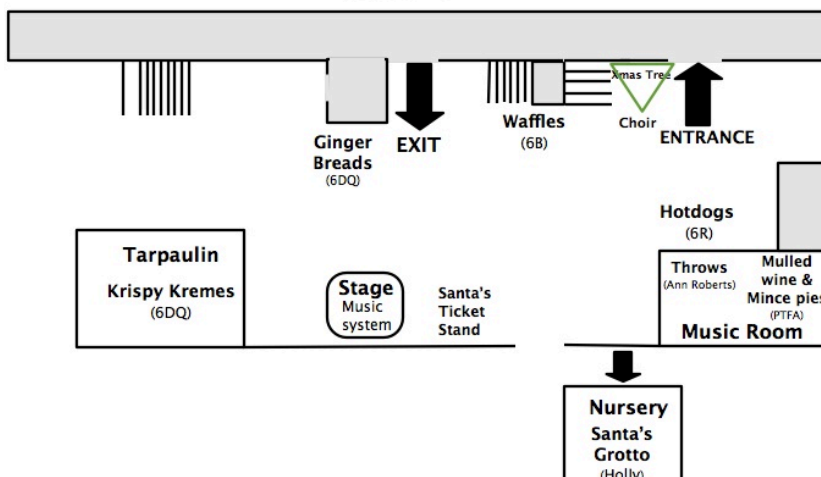

- Outside**
- 1/Ginger Breads
 - 2/Waffles
 - 3/Choir
 - 4/Krispy Kremes
 - 5/Santa's Ticket Stand
 - 6/Hotdogs
- Music Room**
- 1/Throws
 - 2/Mulled Wine & Hot Chocolate
- Nursery**
- Santa's Grotto